

 **BLACK &  
DECKER**®

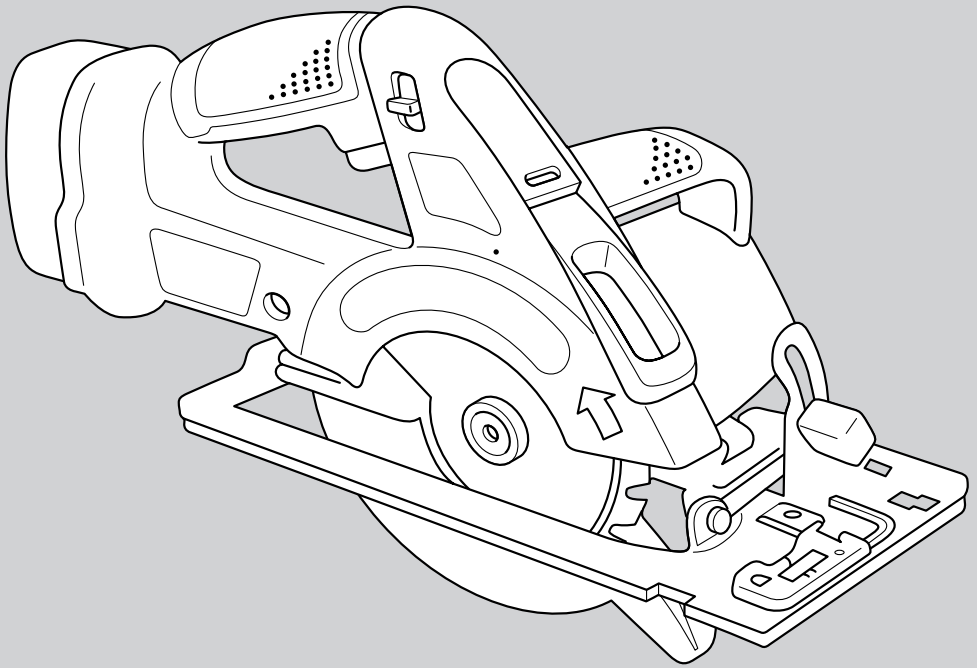

**KC1440SK**

# Cordless saw user manual

## SAFETY INSTRUCTIONS

**Warning!** When using electric tools, the following basic safety precautions should always be taken to reduce the risk of fire, electric shock and personal injury. Read all these instructions before attempting to operate this product and save these instructions.

### For safe operation:

- We recommend that you take appropriate measures for the protection of hearing if the sound pressure of 85 dB (A) is exceeded.
- **Keep the work area clean.** Cluttered areas and benches invite injuries.
- **Consider work area environment.** Do not expose power tools or chargers to rain. Do not use power tools in damp or wet locations. Keep work area well lit. Do not use power tools in the presence of flammable liquids or gases.
- **Guard against electric shock.** Avoid body contact with earthed or grounded surfaces (e.g. pipes, radiators, ranges, refrigerators).
- **Keep children away.** Do not let visitors touch the tool or extension cord. All visitors should be kept away from work area.
- **Store idle tools.** When not in use, tools and batteries should be stored in a dry, high or locked place, out of reach of children.
- **Do not force the tool.** It will do the job better and more safely at the rate for which it was intended.
- **Use the right tool.** Do not force small tools or attachments to do the job of a heavy duty tool. Do not use tools for purposes not intended; for example, do not use a circular saw to cut tree limbs or logs!
- **Dress properly.** Do not wear loose clothing or jewellery as they can be caught in moving parts. Rubber gloves and non-skid footwear are recommended when working outdoors. Wear protective hair covering to contain long hair.
- **Use safety glasses.** Use a face or dust mask if the cutting operation is dusty or if using in enclosed spaces.
- **Secure your work.** Use clamps or a vice to hold your work. It is safer than using your hand and it frees both hands to operate the tool.
- **Do not overreach.** Keep proper footing and balance at all times.
- **Maintain tools with care.** Keep tools sharp and clean for better and safer performance. Follow instructions for lubricating and changing accessories. Keep handles dry, clean and free from oil and grease.

- **Remove adjusting keys and wrenches.** Form the habit of checking to see that keys and adjusting wrenches are removed from tool before switching it on.
- **Avoid unintentional starting.** Do not carry a tool with a finger on the switch.
- **Stay alert.** Watch what you are doing. Use common sense. Do not operate when you are tired.
- **Check damaged parts.** Before further use of the tool, a guard or other part that is damaged should be carefully checked to determine that it will operate properly and perform its intended function. Check for alignment of moving parts, binding of moving parts, breakage of parts, mounting and any other conditions that may affect its operation. A guard or other part that is damaged should be properly repaired or replaced by an authorised service centre unless otherwise indicated in this instruction manual. Have defective switches replaced by an authorised service agent. Do not use the tool if the switch does not turn it on and off.
- **Warning!** The use of any accessory or attachment, other than recommended in this instruction manual, may present a risk of personal injury.
- **Have your tool repaired by a qualified person.** Repairs should only be carried out by qualified persons using original spare parts, otherwise considerable danger to the user may result.
- This electrical appliance is in accordance with the relevant standards.

### Charger plug and cable

- Do not tug at the cable to pull the plug from the socket.
- Make sure the cable is located so that it will not be stepped on, tripped over, or otherwise subjected to damage or stress.
- Keep the cable away from heat, oil, sharp edges and rough surfaces and always ensure it is in good condition.

## ADDITIONAL SAW AND CHARGER SAFETY INSTRUCTIONS

- **Danger!** 240 volts are present at the charging terminals. Do not probe with conductive objects or you will risk an electric shock.
- **Danger!** If the energy pack case is cracked or damaged, do not insert into the charger or you will risk an electric shock.
- The charger is designed for indoor use only.
- **Do not operate the charger** if it has received a sharp blow, been dropped, or otherwise damaged in any way. Take it to a Black & Decker authorised repairer.

- **Never** attempt to connect two chargers together.
- **Always disconnect the supply** before making or breaking connections to the battery.
- Be aware that this tool is always in an operating condition, because it does not have to be plugged into an electrical outlet. Keep the switch control lever in the "Off" position when the tool is not in use or when changing accessories.
- When drilling or driving screws into walls, floors etc., check wherever "live" electrical wires may be encountered. **Do not touch any front metal parts of the tool!** Hold the tool only by the plastic housing.
- **Do not** store the tool in locations where the temperature may reach or exceed 50°C (120°F) (such as outside sheds or metal buildings in summer).
- **Do not** incinerate the saw even if it is severely damaged or completely worn out. The battery pack can explode in a fire.
- A small leakage of liquid from the battery cells may occur under extreme usage, charging or temperature conditions. This does not indicate a failure. However, if the outer seal is broken and this leakage gets on your skin:
  - Wash quickly with soap and water.
  - Neutralise with a mild acid such as lemon juice or vinegar.
  - If battery liquid gets into your eyes, flush them with clean water for a minimum of 10 minutes and seek immediate medical attention. (Medical note: The liquid is a 25-35% solution of potassium hydroxide.)
- **Do not** attempt to open the housing of your drill or charger.
- The supply cord of the charger should not be replaced by the customer; if the cord is damaged it should be replaced at an authorised Black & Decker service repair agent.
- Ensure that the battery pack is correct for the tool.
- Ensure that the outside surface of the battery pack or tool is clean and dry before plugging into the charger.
- Ensure that the battery is charged using the correct charger provided with the tool or recommended by the manufacturer. Incorrect use may result in a risk of electric shock, overheating or leakage of corrosive liquid from the battery.
- **Do not** attempt to recharge non-rechargeable batteries.

## ADDITIONAL SAFETY RULES FOR CIRCULAR SAWS

### When sawing

- Remove all nails and metal objects from the workpiece before starting work.
- Do not attempt to saw extremely small workpieces.
- After switching OFF, never attempt to stop the saw blade by pressing against the side of the blade.
- Never put the saw down on a table or work bench unless switched OFF.

### Operational protection devices

- The circular saw must only be used for cutting wood or plastic.
- Ensure that all devices screening the saw blade are in perfect working order.
- Never jam the saw blade guards.
- Free a jammed saw blade guard immediately and do not use the saw if the guard is jammed.
- Do not remove the riving knife.
- The riving knife should be correctly set; the distance between the toothed rim and the riving knife should be max. 5 mm and the height difference between the riving knife and the toothed rim should be max. 5 mm (fig. E).

### Checking and changing the saw blade

- Only saw blades conforming to the specifications contained in these operating instructions may be used.
- Saw blades made of high alloy, high speed steel (HSS steel) should not be used.
- Only sharp saw blades in perfect working condition should be used; cracked or bent saw blades should be discarded and replaced at once.
- Ensure that the saw blade is securely fixed and rotates in the correct direction.

### Special applications

- When cutting narrow workpieces (width less than 80 mm) longitudinally, use a rip fence guide (rip fence spare part not included) along the longitudinal edge.
- When sawing with the workpiece clamped tight, devices should be used to prevent the workpiece kicking back.
- When sawing circular sections of wood use a device to hold the workpiece steady on both sides of the saw blade to prevent slipping.
- Ensure that pieces of wood sawn off the workpiece cannot be caught up by the teeth of the saw blade and thrown in the air.

# ENGLISH

## Guard against kickback

- Kickback occurs when the saw begins to stall rapidly and is driven back towards the operator. Release the switch immediately if the blade sticks or the saw stalls.
- Keep the saw blades sharp.
- Supports large panels near the cutting area.
- Use a fence or straight edge guide when ripping; do not force the tool.
- Do not remove the saw from the work during a cut while the saw blade is rotating.

For replacement or detachable fuse covers, contact a Black & Decker authorised repair agent.

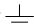
**Warning!** Never connect live or neutral wires to the earth pin marked E or .

## FUSE REPLACEMENT ON 1 HOUR CHARGER (UK ONLY)

- If you are using a 1 hour charger the plug is fitted with a 3 or 5 amp fuse which should only be replaced with an identical fuse approved to BS1362.

**Note:** Fuses do not give personal protection against electric shock.

- After changing the fuse in your plug always ensure the fuse cover is refitted. If the fuse cover is missing or damaged do not use the plug. For replacement or detachable fuse covers contact a Black & Decker authorised repair agent.

## EXTENSION CABLES

Up to 30m (100ft) of Black & Decker 1.00mm<sup>2</sup>, 2-core extension cable (or 3-core extension cordset, in Australia and New Zealand) can be used without undue loss of power. **Note:** An extension cable should not be used unless absolutely necessary. Use of an improper extension cable could result in a risk of fire and electric shock. If an extension cable must be used, make sure it is properly wired, contains the correct rated fuse as recommended in its literature and is in good electrical condition.

## UNWANTED TOOLS AND THE ENVIRONMENT

 Should you find one day that the tool needs replacement or is of no further use, think of the protection of the environment. Black & Decker service agents will accept old tools and will dispose of them in an environmentally safe way.

## THE BLACK & DECKER GUARANTEE (UK, AUSTRALIA AND NEW ZEALAND ONLY)

If the Black & Decker product becomes defective due

to faulty materials and workmanship, within 24 months from the date of purchase, we guarantee to either replace all defective parts or at our discretion, replace the unit free of charge provided that:

- The product is returned to us or our authorised repairers with evidence of date of purchase.
- The product has not been used for trade, professional or hire purposes.
- The product has not been subjected to misuse or neglect.
- The product has not sustained any damage through foreign objects, substances or accidents.
- Repairs have not been attempted by anyone other than our authorised repair distributors.

This guarantee is offered as an extra benefit and is additional to the customers statutory rights.

## AFTER SALES SERVICE FOR THE BLACK & DECKER PRODUCT (UK, AUSTRALIA AND NEW ZEALAND ONLY)

Black & Decker offers a nationwide network of authorised service agents. The use of other than genuine Black & Decker accessories and parts may damage or reduce the performance of your Black & Decker product and may also endanger the user. The terms and conditions of the warranty may also be effected.

## OUR AFTER SALES SERVICE POLICY (UK, AUSTRALIA AND NEW ZEALAND ONLY)

It is our aim that all Black & Decker customers should be totally satisfied with their Black & Decker product and after sales service, but if help or advice is needed please contact your local Black & Decker authorised repair agent who will be happy to help. Full details of our after sales service and a list of these agents can be found on the Internet at [www.2helpU.com](http://www.2helpU.com). Alternatively, call our Service and Information Centre whose number you will find towards the back of this manual.

## ACCESSORIES

Black & Decker offer a complete range of sawblades. We recommend that only Black & Decker accessories are used.

## EXTRA BATTERIES

You can buy an extra battery to improve the run time capacity of your saw. Only buy a Black & Decker battery of the same voltage as your circular saw.

**Only use Black & Decker batteries.**

TECHNICAL DATA		KC1440SK
Voltage (V)		14.4
Current (A)		
Watts (W)		
No load speed (rpm)	min	2,200
Blade diameter (mm)	mm	136
Blade bore (mm)	mm	10
Blade bore thickness	mm	1.1
Max depth of cut (mm)	mm	41
Weight (kg)		3

## ELECTRICAL SAFETY

Be sure the supply is the same as the voltage given on the rating plate. Your charger is fitted with a two-core cable and plug.

## MAINS PLUG REPLACEMENT

Should the mains plug or cordset of the product be damaged, it must only be replaced by an authorised Black & Decker service agent because special purpose tools are required.

## MAINS PLUG REPLACEMENT ON 1 HOUR CHARGER (UK ONLY)

If you are using a 1 hour charger and the mains plug needs replacing, and you are competent to do this, proceed as instructed below.

If you are in doubt, contact a Black & Decker service agent or a qualified electrician.

- Disconnect the plug from the power supply.
  - Cut off the plug and dispose of safely. A plug with bared copper conductors is very dangerous if engaged in a live socket outlet.
  - Only fit BS1363A approved plugs fitted with the correctly rated fuse.
- Note:** Fuses do not give personal protection against electric shock.
- The cable wire colours, or a letter, will be marked at the connection point of most good quality plugs. Attach the wires to their respective points in the plug (see diagram). Brown is L (live) and blue is N (neutral).

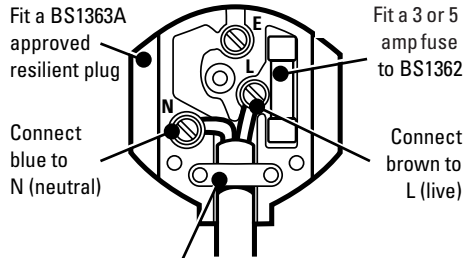

Make sure that the outer sheath of the cable is held firmly by the clamp



230 volts AC only  
Never use a light socket

- Before replacing the top cover of the plug ensure that the cable restraint is holding the outer sheath of the cable firmly and that the two leads are correctly fixed at the terminal screws. If the fuse cover is missing or damaged do not use the plug.

## TECHNICAL DATA

The level of sound pressure of the tool is in accordance with EEC legislation. It is recommended that you take appropriate measures for the protection of your hearing if the sound level seems uncomfortable. This normally equates to a sound pressure in excess of 85dB (A).

**Note:** This user manual also covers catalogue numbers ending with a letter suffix. Refer to your carton for details of your product.

## FEATURES

1. Battery pack
2. On/off switch
3. Saw shoe
4. Riving knife
5. Guard retracting lever
6. Blade guard
7. Lock-off button
8. Front handle
9. Window Unlock spring
10. Window
11. Mitring angle scale
12. Locking screw for mitring adjustment
13. Sight guide
14. Mark for straight cut
15. Mark for mitring cut
16. Depth of cut adjustment
17. Blade
18. Depth of cut scale
19. Saw blade locking screw

# ENGLISH

- 20. Outer washer
- 21. Inner washer
- 22. Allen key

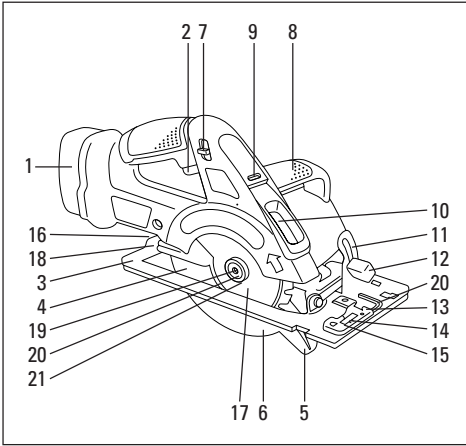

## SAFETY WARNING

Your saw is designed for use with wood cutting blades only. Do not use stone cutting or metal cutting discs.

## PREPARING YOUR CIRCULAR SAW

### SETTING THE DEPTH OF CUT ADJUSTMENT

Proceed as follows:

Loosen the depth of cut adjustment (16) at the bottom of the scale. Move your circular saw up the scale until the desired depth of cut is indicated on the scale (18).

Tighten the screw (16). The depth of cut should be 3mm greater than the thickness of the workpiece.

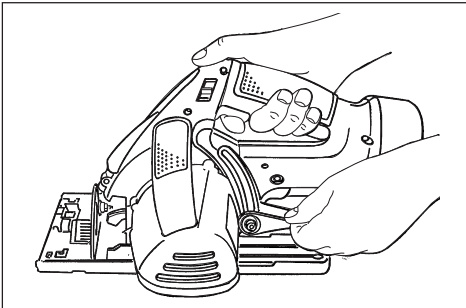

### SETTING THE SIGHT GUIDANCE SYSTEM

The window and 'sight guide' are designed to enable accurate cutting everytime the saw is used.

To prepare the guide system for first time use, proceed as follows:

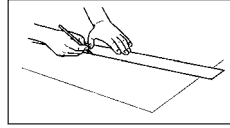

Mark a straight line on your workpiece to represent the desired path of the saw blade.

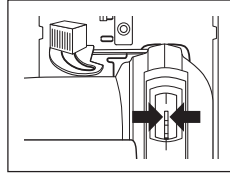

Whilst viewing through the saw guard window align the saw blade teeth with the intended line of cut drawn on the workpiece.

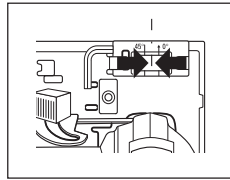

Whilst keeping the saw in this position, place the orange 'sight guide' (13) onto the shoe of your circular saw. Align the 'sight guide' with the line drawn on the workpiece

and secure in place with the screw provided.

- At the start of every cut align the blade as described and whilst cutting keep the 'sight guide' in line with the intended line of cut drawn on the workpiece.
- When attempting mitre cuts, follow the same procedure detailed above, however, use the area marked 45° on the 'sight guide'.

### SETTING THE MITRING ADJUSTMENT

Your circular saw can cut at angles up to 45°. To adjust the angle of your circular saw, proceed as follows:

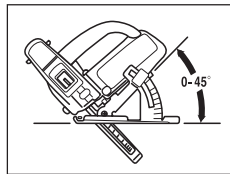

Loosen the locking screw (12). Move your circular saw around the mitre scale (11) until the desired angle is indicated. Tighten the locking screw (12).

### CHANGING THE BLADE

Proceed as follows:

Disconnect the Battery pack and Retract the blade

guard (6). Insert a screwdriver through the hole in the blade to prevent rotation of the blade.



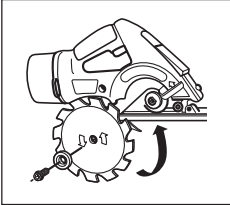

Unlock and remove screw (19). Loosen anticlockwise using the allen key (22), remove the outer washer (20) and remove the blade. Insert the new blade, ensuring that the arrow

on the blade points in the same direction as the arrow on the body of your circular saw. Fit the outer washer (20). Ensure that this washer is correctly located on the flats of the spindle. Fit the saw blade locking screw (19). Insert a screwdriver through the hole in the blade to prevent rotation of the blade. Tighten the sawblade locking screw clockwise using the allen key (22).

### ADJUSTING THE RIVING KNIFE

The riving knife (4) prevents the saw blade from jamming during rip sawing operations. You must check the position of the riving knife whenever the saw blade is replaced, or whenever the clearance is affected. Proceed as follows:

Disconnect the battery at the rear of the unit.

Disconnect the battery at the rear of the unit.

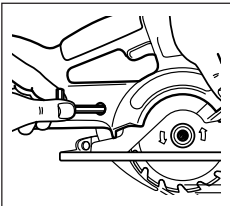

Through the opening in the upper blade guard, locate the riving knife screw. Use allen key (22) to loosen the riving knife screw. Adjust the riving knife to give a radial clearance of 2-3mm and a tooth peak clearance of 2-3mm. Tighten the riving knife screw.

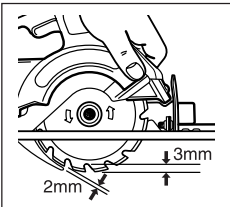

**Your saw is now ready for use.**

### OPERATING YOUR CIRCULAR SAW

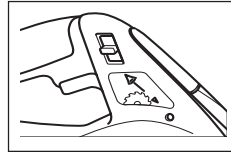

To switch your circular saw on, depress the lock-off button (7) and squeeze the on/off trigger switch (2). To stop your circular

saw, release the trigger switch.

### HOLDING YOUR CIRCULAR SAW

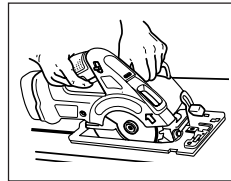

The front handle (8) makes it easier to guide the saw properly. Switch the machine on before you start sawing the workpiece. Guide the saw without pushing it

and give the blade time to pursue its path. Use the mark (14) for straight cuts or the mark (15) for mitring cuts, to keep to the line you have drawn.

### MAINTENANCE OF THE WINDOW

From time to time, it may become necessary to remove cutting debris/dust from the inside of your circular saw window.

To do this, proceed as follows:

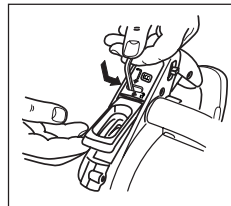

Disconnect the battery pack (1) from the Saw. Remove the allen key (22) from the 'sight guide' (13), and insert into the left of (9). Push the spring to the right, and lift the window

up until it will not go any further, do not force it open. It can now be cleaned with a lint free cloth. Let the window close and replace the allen key (22) to sight guide (13).

**Note:** If necessary, use only mild soap to clean your saw as many household cleaners contain chemicals which could seriously damage the plastic. Also, do not use petrol, turpentine, laquer or paint thinners or similar products. Never let any liquid get inside your circular saw and never immerse any part of it into liquid.

# ENGLISH

## FAST CHARGER AND DETACHABLE BATTERY PACK

Your drill has a fast charger and detachable battery pack. To increase the availability of your drill you can purchase an additional battery pack as an accessory or spare part.

## CHARGING YOUR CIRCULAR SAW

**Important!** The battery pack in your circular saw is not charged when supplied as new. A new battery, or one which has not been used for an extended period, achieves full performance only after approximately 5 charging and discharging cycles.

Before attempting to charge your circular saw, read all the safety instructions.

To charge your circular saw, proceed as follows:

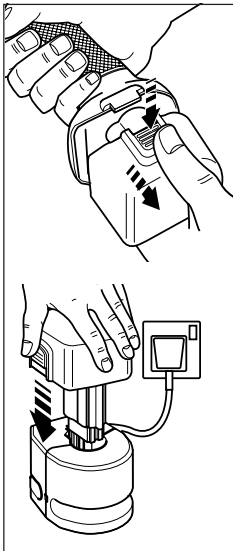

To remove the battery pack, depress the two release buttons and withdraw the battery pack.

Plug the charger into a standard 220/240V socket.

Place the battery pack in the charger. While charging, your battery pack may hum and become warm to the touch; this is normal.

After normal usage your power pack should be fully charged in 3 hours or less. If your power pack is run down completely it may take up to 8 hours to become

fully charged. Your power pack was sent from the factory in an uncharged condition; before attempting to use it, it must be charged for at least 6 hours.

To prolong your power packs life, avoid leaving it on charge for more than 8 hours. Although overcharging is not a safety concern, it can reduce the overall life of your power pack.

Disconnect the plug from the electricity supply before making or breaking connections to the battery pack. For the longest battery life, charge the battery pack in an air temperature of approximately 24°C/75°F. Do not charge the battery pack if the air temperature is below 5°C/41°F or above 35°C/95°F.

If the electricity supply is satisfactory and your saw is still not charging, take or send your saw and charger to your local Black & Decker authorised repair agent.

## RECHARGEABLE BATTERIES AND THE ENVIRONMENT

Black & Decker cordless tools use nickel cadmium (NiCad) batteries or battery packs which can be charged many times to give long life and repeatedly full power.



This symbol indicates the NiCad batteries contained within this unit must be disposed of properly and not discarded in everyday household waste which may be disposed of in an incinerator or landfill site.

NiCad batteries can be harmful to the environment and can explode when exposed to fire.

### Do not incinerate.

Therefore, when your tool or battery pack needs replacing, think of the protection of our environment.

Black & Decker recommends the following:

- Discharge batteries completely by running the unit until the energy is completely discharged and then remove from the tool.
- Take the battery pack to your local dealer or your local recycling station. If necessary, contact your local council for disposal information. The collected batteries will be disposed of properly and/or used for recycling purposes whilst protecting the environment.

**Note:** You as a customer are responsible for proper disposal or recycling of the battery pack.

## Save these instructions

### HANDY HINTS

Some splintering is inevitable on the topside line of cut. It is therefore desirable to cut on the side of the workpiece where splintering is acceptable. This is especially important when cutting laminates.

### TOOL CARE

- Guide your circular saw but do not force it through the work. Applying excessive pressure can cause your circular saw to overheat. If your circular saw becomes too hot, operate it off-load for 2 minutes.
- Always keep the air cooling vents on the motor housing clear.



## **EC DECLARATION OF CONFORMITY**

We declare that units:

### **KS1440SK**

conform to 98/37/EC, 89/336/EEC, EN55014,

EN60335, EN55104, EN50144, EN61000

A weighted sound pressure 73.5dB (A)

A weighted sound power 83.5dB (A)

Hand/arm weighted vibration  $<2.5\text{m/s}^2$



Colin Wills - Director of Engineering  
BDCl, 4/F, 2 Dai Wang Street, Tai Po Industrial Estate,  
Tai Po NT, Hong Kong

The Black & Decker policy is one of continuous improvement to our product and as such we reserve the right to change the product specification without prior notice.

---

<b>Australia</b>	DeWalt Industrial Power Tool Company (Distributors of Black & Decker products) 7 Clarice Road, Box Hill, Victoria 3128	Tel: 03 9895 9200 Fax: 03 9899 7465
<b>New Zealand</b>	Black & Decker 483 Great South Road Penrose, Auckland	Tel: 09 579 7600 Fax: 09 579 8200
<b>South Africa</b>	Black & Decker South Africa (Pty) Ltd Suite no 107, PostNet X65 Halfway House 1685	Tel: 011 314 4431 Fax: 011 314 4435
<b>United Kingdom</b>	Black & Decker 210 Bath Road, Slough Berkshire SL1 3YD	Tel: 01753574277 Tlx: 848317 BAND MH Fax: 01753551155

---

Forhandler adresse  
Händleradresse  
Διεύθυνση αντιπροσώπου  
Address of dealer  
Dirección del detallista  
Cachet du revendeur  
Indirizzo del rivenditore  
Adres van de dealer  
Forhandlerens adresse  
Morada do revendedor  
Jälleennyijän osoite  
Aterförsäljarens adress

Indköbsdato  
Kaufdatum  
Ημερομηνία αγοράς  
Date of purchase  
Fecha de compra  
Date d'achat  
Data d'acquisto  
Aankoopdatum  
Innkjøpsdato  
Data de compra  
Ostopäivä  
Inköpsdatum

Navn/Name/Όνομα/Nombre/Nom/  
Nome/Naam/Навн/Nome/Nimi/Namn:  
  
Adresse/Adresse/Διεύθυνση/Address/  
Dirección/Adresse/Indirizzo/Adres/Adresse/  
Morada/Osoite/Address:

By/Wohnort/Πόλη/Town/Ciudad/Ville/Città/  
Plaats/By/Localidade/Paikkakunta/By:  
  
Postnr./P.ostleitzahl/Κωδικός/Postcode/  
Code postal/Código/Codice postale/P.ostcode/  
Postnr./Código postal/Postnummera/Postnr.:

Er maskinen en gave?/Ist diese Maschine ein  
Geschenk?/Η μηχανή είναι δωρό?/Is this  
product a gift?/¿Ha recibido usted esta  
herramienta como regalo?/S'agit-il d'un  
cadeau?/Si tratta di un regalo?/Kreeg u deze

machine cadeau?/Er maskinen en gave?/  
Recebeu esta ferramenta como presente?/  
Onko kone lahja?/Är maskinen en gåva?  
 Ja/Ja/Ναι/Yes/Si/Oui/Sì/Ja/Ja/Ja/Stim/  
Kyllä/Ja  
 Nej/Nein/Όχι/No/Non/No/Nei/Nei/  
Näo/Ei/Nej

Hvor meget kostede maskinen?/Was war der  
Preis dieses Werkzeuges?/Ποιά είναι τιμή  
του εργαλείου αυτού?/What was the price of  
this tool?/¿Cual fue el precio de esta  
herramienta?/Prix payé?/Quanto ha pagato  
questo prodotto?/Wat was de prijs van dit  
product?/Hvor meget kostet maskinen?/Que  
preço pagou por esta ferramenta?/Paijonko  
kone maksoi?/Hur mycket kostade maskinen?

Er dette din første B&D maskine?/Ist dieses  
Werkzeug/Eivaitto εργαλείο αυτό-/Is this tool-  
/¿Es esta herramienta que comprado-/Est-ce-/  
Questo prodotto è-/Is deze machine-/Er dette  
din første B&D maskin?/Esta ferramenta é-/  
Onko tämä ensimmäinen B&D-koneesi?/  
Är detta Din första B&D-velu?

Ja/ein Er-stkauf?/η πρώτη σας αγορά?/  
your first purchase?/la primera de  
este tipo?/un ler achat?/il suo primo  
acquisto?/uw eerste aankoop?/Ja/Ja/  
sua primeira compra?/Κυllä/Ja  
 Nej/Ersatzkauf?/για αντικατάσταση?/a  
replacement?/un reemplazo?/un  
achat de remplacement?/una  
sostituzione?/een vervanging?/Nei/  
uma substituição?/Ei/Nej

Forhandler adresse/Händleradresse/Διεύθυνση  
αντιπροσώπου/Address of dealer/Dirección del  
detallista/Cachet du revendeur/Indirizzo del  
rivenditore/Dealeradres/Forhandlerens  
adresse/Morada do revendedor/Jälleennyijän  
osoite/Aterförsäljarens adress:

• Venligst sæt kryds i ruden såfremt De  
ikke måtte ønske at modtage information  
fra anden virksomhed end Black & Decker.  
• Bitte ankreuzen, falls Sie weiteres  
Informationsmaterial von Black & Decker  
erhalten möchten. • Παράκαλεσθε να  
σημειώσετε εάν δεν θέλετε να πάρετε  
πληροφορίες άλλης εταιρείας εκτός της  
Black & Decker. • Data protection act: Tick the  
box if you prefer not to receive information from  
us or others. • Señale en la casilla si quiere  
cochez cette case. • Barrate la casella se non  
recibir informació de otras empresas. • Si vous  
ne souhaitez pas recevoir d'informations de la  
part d'autres sociétés que Black & Decker,  
cochez cette case. • Barrate la casella se non  
desiderate ricevere informazioni da altre  
aziende. • A.u. bit vilkje ankreuze inden u  
geen informatie wenst te ontvangen van andere  
bedrijven dan Black & Decker. • Vennligst kryss  
av dersom De ikke ønsker informasjon fra andre  
bedrifter enn Black & Decker. • Por favor,  
assinale com uma cruz se desejar receber  
informação de outras empresas, além da  
Black & Decker. • Merkitkää rasti ruutuun, mikäli  
ette halua vastaanottaa informaatiota muulta  
taholta kuin Black & Deckeriltä. • Vänligen  
kryssa för i rutan om Ni inte vill ha information  
från andra företag än Black & Decker.

Cat. no. KC1440SK



## **GUARANTEE CARD FOR THE UK, IRELAND AND SOUTH AFRICA**

**South Africa:** Black & Decker South Africa (Pty) Ltd, Suite no 107, PostNet X65, Halfway House 1685

**United Kingdom & Ireland:** P O Box 821, Slough, Berkshire, SL1 3AR



Please complete this section immediately after the purchase of your cordless drill  
and post it to the Black & Decker address in your country (above).